



# etc.venues Manchester, Piccadilly

11 Portland Street, Manchester M1 3HU

- Meetings range from 10 to 300 people
- Located in a contemporary mixed-use building offering views of the city centre, the design of the space reflects the vibrance of Manchester with colorful furnishings and eclectic artwork
- Ideal for corporate trainings and the self-contained private event wing is best suited for conferences or internal meetings



NEARBY PUBLIC  
TRANSPORTATION



TURNKEY SPACES



SHARED HOSPITALITY  
RESOURCES



WIFI INCLUDED



COMMUNAL  
CATERING-OF-THE-DAY



SELECT SIGNAGE  
OPPORTUNITIES

SQUARE METERS

1,765

MEETING ROOMS

15

LARGEST CAPACITY ROOM

300



ADMIRE



PANORAMA SUITE



# etc.venues Manchester, Piccadilly

11 Portland Street, Manchester M1 3HU

## EIGHTH FLOOR

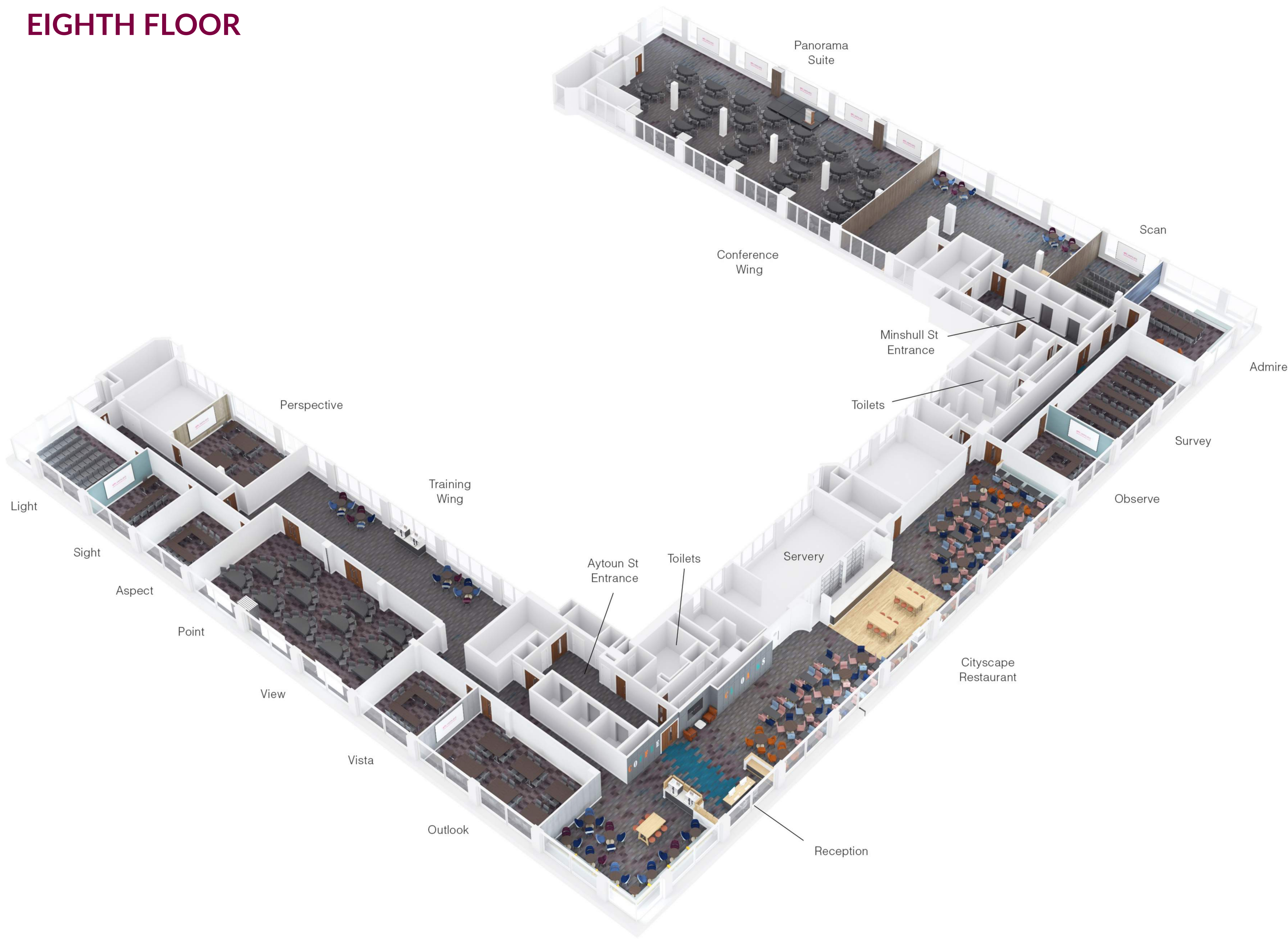

ROOM NAME	AREA [SQ M]	THEATER	BANQUET	CABARET	CLASSROOM	U-SHAPE	BOARDROOM
PANORAMA SUITE	348	300	230	168	136	-	-
PANORAMA LOUNGE	143	-	-	-	-	-	-
PANORAMA 2 + 3	283	250	180	132	106	-	-
PANORAMA 1	51	35	20	18	16	-	-
PANORAMA 2	110	80	70	48	36	-	-
PANORAMA 3	91	55	50	36	18	-	-
VIEWPOINT	124	128	70	72	54	30	48
VIEW	81	88	-	42	36	22	32
POINT	43	35	-	18	18	16	20
SURVEY	60	72	-	36	30	24	28
OUTLOOK	55	56	-	36	30	24	28
LIGHT	41	42	-	24	24	16	20
PERSPECTIVE	45	42	-	24	24	16	20
SCAN	37	35	-	18	16	16	20
OBSERVE	30	24	-	12	12	10	12
VISTA	29	21	-	12	12	10	12
SIGHT	29	21	-	12	10	10	12
ASPECT	29	21	-	12	10	10	12
ADMIRE	62	-	-	-	-	-	10